

# LANDMARK

AT WATERFRONT



The home is encased by a long wrap-around patio, accessible from the open-concept living area, master and secondary bedrooms. An incredible amount of space and storage is offered throughout.



## Residence 101

3 BEDROOM + 3.5 BATH

INTERIOR: 2,516 SF

EXTERIOR: 827 SF

~~~~~~ BOW RIVER ~~~~~~

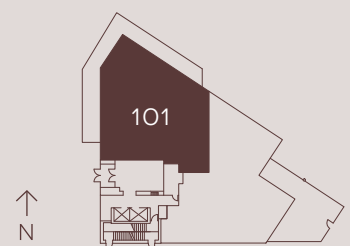

Level 1

The developer reserves the right to make changes and modifications to the information contained herein. Floorplans and floorplates are subject to change without notice. Please contact a developer sales representative for details. The developer may also make such further development modifications as are permitted by the disclosure statement, as may be amended, the contract of purchase and sale between a purchaser and developer (if applicable), or otherwise. E. & O.E.